

Product Catalogue

Fitzroy Profile and Canterbury Classic Series 2014

Cannon
Gas Log Heaters

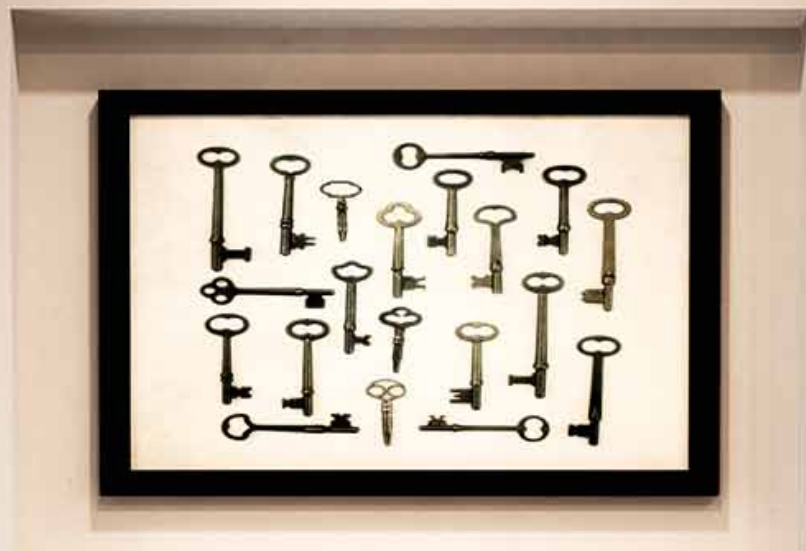



Canterbury Classic Freestanding (CANTFS-SDEEB)

Share a lifetime of cosy moments with Cannon Gas Log Heaters.

Hot chocolate with marshmallows, cuddles and chats are just a few of the cosy moments that you can enjoy in front of a Cannon Gas Log Heater. Providing you with rapid warmth and the romance of a real log fire without the mess, a Cannon Gas Log Heater is simple to operate and energy efficient.

Cannon Gas Log Heaters are designed and manufactured in Australia for Australian conditions. They provide all of the warmth and atmosphere of a flickering log fire – without the work. With all Cannon Gas Log Heaters every attention is given to pursuing superb design, excellent energy efficiency, high heat output, safety, style, performance and reliability to the highest level. With a number of models in the collection, Cannon Gas Log Heaters will suit all room styles from contemporary to classic, complementing and enhancing any home.

Cannon Gas Log Heaters are warranted to be free from defects in materials, workmanship and manufacturing to the original purchaser for 3 years and the highly efficient heat exchanger is backed by a 10 year parts warranty. Cannon Gas Log Heaters are proudly manufactured, distributed and supported by Sampford IXL in Australia.

Contents

Installation Options	4 – 5
Fitzroy Profile Inbuilt	6 – 7
Fitzroy Profile Powerflue	8 – 9
Canterbury Classic Powerflue	10 – 11
Canterbury Classic Freestanding	12 – 13
Canterbury Classic Inbuilt	14 – 15
How to build a mock fireplace	16
Mock fireplace opening dimensions	16
Powerflue installation options	17
Cannon heater options	
Weatherproof box dimensions	18
Surround & spacer kit dimensions	18
Console kit dimensions	18
Specifications	
Fitzroy Profile series – heater specifications	19
Canterbury Classic series – heater specifications	20
Standard features & optional accessories	21
Fitzroy Profile series – dimensions	22
Canterbury Classic series – dimensions	23



1.



2.



3.



4.



5.



6.



7.



8.

3 and 4 sided
surrounds available



9.

Versatility and flexibility are key components of our installation options. Install in a shallow recess or an existing fireplace, elegant spacers will eliminate any size discrepancies. To enhance your Cannon's appearance add a decorative 3 or 4 sided surround.

Every Cannon heater brings you the optional convenience of controlling your heater through a remote thermostat.

For added convenience the heater can now be connected to a home automation system, such as C-bus. This allows the heater to be turned on or off remotely (medium heat setting only).

Installation options

1. Fitzroy mesh guard

The Fitzroy Profile models are supplied with a dual glass fascia which can be easily swapped over to a mesh safety guard, as both are fully interchangeable. The Fitzroy mesh guard is strong and durable and designed to be used to protect young children that may get too close to the heater.

2. Remote thermostat

The remote has an LCD display and the ability to set hour, minute and day functions, plus up to 28 programmable periods. It also has manual and automatic modes and can't be accidentally turned on – child lock feature built in.

3. Spacer kit

When installing into a shallow fireplace cavity, the 50 mm spacer kit helps to provide the minimum clearance at the rear by bringing the heater forward.

4. Canterbury mesh guard

Our mesh guard is strong, tough and safe. Engineered for the ultimate in protection, there is a mesh guard available for both the inbuilt and freestanding Canterbury models.

5. Fitzroy freestanding kit

The Fitzroy freestanding kit converts the FITZIB-SDENB inbuilt heater into a freestanding unit. The kit comes complete with the pedestal, outer casing and flue kit. Refer to pages 19 and 22 for further details.

6. Mock fireplace kit

The mock fireplace kit ensures the inbuilt Cannon heaters can be installed safely into combustible areas such as timber or plasterboard mock fireplaces.

7. Console kit

A decorative cover that fits around the heater to allow installation against an existing wall without building a mock fireplace or installing a mantelpiece.

8. Surround kit

Decorative surround kits allow the heater to be installed into existing fireplaces where the fireplace opening is larger than the heater. Available in black, platinum or stainless steel, 3 sided or 4 sided surround. See page 18 for details and measurements.

9. Weatherproof box

The weatherproof box is designed to protect the back of the Powerflue heaters from the elements when installed on an external wall without a mock fireplace.



FITZIB-SDENB heater shown with optional 3 sided black surround FITZSURROUND3SX-B

Standard features

- + Electronic ignition and controls
- + 3 heat and fan speed settings
- + Realistic eucalypt look logs
- + Double glazed glass fascia
- + Black finish (FITZIB-SDENB)
- + Metallic platinum finish (FITZIB-SDENP)

- + Heats 80 m² on average
- + 3.6 star energy rating
- + 4 continuously monitored safety systems

Options

- + Fitzroy freestanding kit
- + Fitzroy mesh guard
- + Remote thermostat
- + Spacer kit
- + Surround kit
- + Console kit
- + Inbuilt flue kit
- + Mock installation kit
- + Chimney plate



FITZIB-SDENB shown with optional Freestanding Kit (FITZFSKITX-B) & Mesh Guard Kit (FITZIBMG-B)

Fitzroy Profile Inbuilt ★ ★ ★ ☆



Designed for Australian needs, the Fitzroy inbuilt has become a proven favourite.

The all new Profile series Fitzroy is supplied with a double glazed glass fascia as standard.

Clean, fuss free design with high efficiency and heat output.

Neatly fits the cavity of existing gas/oil space heaters.

A mock installation kit makes your heater suitable for installation with timber or plasterboard (combustible surfaces). Refer to website for mock fireplace installation specifications.



FITZIB-SDENB



FITZIB-SDENP



FITZIB-PDEXP heater shown with optional metallic platinum 4 sided surround SURROUND4SX-P

Standard features

- + Electronic ignition and controls
- + 3 heat and fan speed settings
- + Realistic eucalypt look logs
- + Double glazed glass fascia
- + Enhanced flame effect
- + Black finish (FITZIB-PDEXB)
- + Metallic platinum finish (FITZIB-PDEXP)
- + Flexible flueing options

- + Supplied with 2 X 50 mm diameter lengths of 400 mm aluminium flexible tubing, an insulating blanket and flue terminal
- + Heats 80 m² on average
- + Suitable for use in 5 star energy rated homes
- + Star energy rating: 5.5
- + 5 continuously monitored safety systems

Options

- + Fitzroy mesh guard
- + Remote thermostat
- + Spacer kit
- + Weatherproof box
- + Surround kit
- + Console kit
- + Extended flue kit

Fitzroy Profile Powerflue ★ ★ ★ ★ ★ ☆



Designed for Australian needs, the Fitzroy Profile Powerflue is more energy efficient than a standard gas space heating system and is ideally suited to well sealed homes and bedrooms where the external flue allows combustion gasses to be vented safely outside.



FITZIB-PDEXB



FITZIB-PDEXP



Supplied with flue terminal as shown and flueing accessories

Cannon Powerflue Gas Log Heaters are also versatile to install – the heater can be placed on any external walls and even in multi-storey apartments.



CANTIB-PDEEP heater shown

Standard features

- + Electronic ignition and controls
- + 3 heat and fan speed settings
- + Realistic eucalypt look logs
- + Curved double glazed glass
- + Enhanced flame effect
- + Black finish (CANTIB-PDEEB)
- + Metallic platinum finish (CANTIB-PDEEP)
- + Flexible flueing options

- + Supplied with 2 X 50 mm diameter lengths of 400 mm aluminium flexible tubing, an insulating blanket and flue terminal
- + Heats 80 m² on average
- + Suitable for use in 5 star energy rated homes
- + Star energy rating: 5.5
- + 5 continuously monitored safety systems

Options

- + Canterbury mesh guard kit
- + Remote thermostat
- + Spacer kit
- + Weatherproof box
- + Surround kit
- + Console kit
- + Extended flue kit

Canterbury Classic Powerflue ★ ★ ★ ★ ★ ☆



5.5 star energy rated, the Powerflue is the ideal choice for the energy conscious. The double pipe system draws air from the outside for combustion and vents the flue gases outside.

Flexible flue options take Cannon Powerflue heaters into new territory.

Clever design flaunts convention, letting you install it on any external wall, even in a multi-storey dwelling.



CANTIB-PDEEB



CANTIB-PDEEP



Supplied with flue terminal as shown and flueing accessories



CANTFS-SDEEB
heater shown

Standard features

- + Electronic ignition and controls
- + 3 heat and fan speed settings
- + Realistic eucalypt look logs
- + Curved double glazed glass
- + Enhanced flame effect
- + Black finish
- + Flue kit (FLUERO-B) supplied
- + Heats 80 m² on average
- + 4 star energy rating
- + 4 continuously monitored safety systems

Options

- + Remote thermostat
- + Canterbury mesh guard kit

Canterbury Classic Freestanding ★ ★ ★ ★



Elegant, curved appearance that effortlessly suits any home.

The double glazed window allows unobstructed viewing of the flames, creating the perfect feel of a log fire in your home.

An impressive energy rating delivers heat effectively.

Can be safely placed on all floor surfaces making it suitable for the family rooms and large living areas of modern Australian homes.



CANTFS-SDEEB



CANTIB-SDEEB heater show

Standard Features

- + Electronic ignition and controls
 - + 3 heat and fan speed settings
 - + Realistic eucalypt look logs
 - + Standard double glazed glass
 - + Enhanced flame effect
 - + Black finish
- + Heats 80 m² on average
 - + 3.1 star energy rating
 - + 4 continuously monitored safety systems

Options

- + Remote thermostat
- + Spacer kit
- + Canterbury mesh guard kit
- + Mock installation kit
- + Surround kit
- + Console kit
- + Inbuilt flue kit
- + Chimney plate

Canterbury Classic Inbuilt ★ ★ ★ ☆



Gently curving front glass that continues through the surround makes a refined, elegant statement.

Safe double glazed glass gives you an unobstructed view of your fire.

Replace old gas /oil space heaters with minimum effort as this particular model only has a depth requirement of 363 mm. If adding the optional 50 mm spacer kit, the depth required is reduced to an incredible 313 mm.

A mock installation kit makes your heater suitable for installation with timber or plasterboard (combustible surfaces).



CANTIB-SDEEB

How to build a mock fireplace

1+2+3+4

Creating the look of a fireplace is simple with Cannon.

If you don't have a fireplace but like the look, our mock fireplace kit is the answer. Using the kit, your inbuilt heater can be easily and safely installed in a plasterboard or timber wall.

Whether flueing up in the wall cavity or through ceiling plaster, simply construct a purpose built timber or plasterboard enclosure to conceal the heater cabinet and flue.

You must use a mock fireplace kit with an inbuilt heater for installation into combustible areas i.e. timber, plasterboard etc. (Mock Fireplace kit included with Powerflue model)

Note: The purpose of the diagrams shown here are to briefly illustrate the steps to install a heater in a mock fireplace. For full details refer to the comprehensive instructions included with the heater or visit www.cannonappliances.com.au

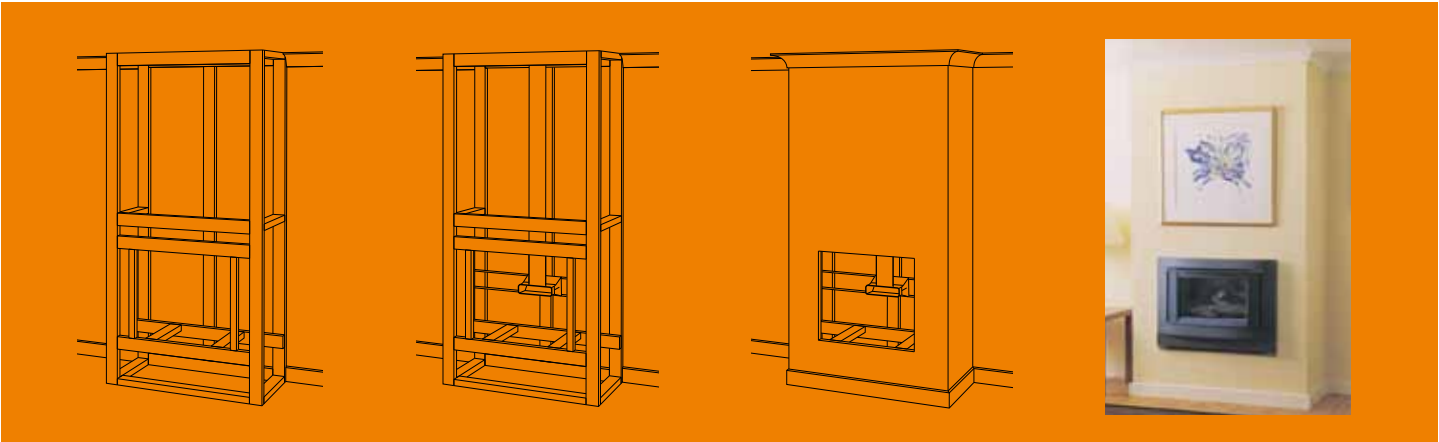

- 1** Choose your location and build a frame to enclose the heater according to your flueing needs. Allow for required clearances between the heater cabinet and combustible surfaces. See below table and refer to mock installation instructions or website for further detailed measurement requirements
- 2** Installation of appropriate self-supported flue which complies with local regulations and manufacturer instructions. Refer to mock installation instructions or website for details on mounting of wall brackets & flue transition (brackets are supplied with mock kit only).
- 3** Use plasterboard or timber panelling to enclose the frame, maintaining appropriate clearances. Plasterboard opening should be cut back level with timber framework.
- 4** Attach the mock fireplace kit to the heater per the instructions. Position the heater in the frame. Refer to mock installation instructions or website for further details on installing mock kit components on heater.

Mock Fireplace Opening (combustible materials)^

	FITZROY INBUILT		FITZROY POWERFLUE		CANTERBURY INBUILT		CANTERBURY POWERFLUE	
	Max	Min	Max	Min	Max	Min	Max	Min
Height	640 mm	630 mm	640 mm	630 mm	640 mm	630 mm	640 mm	630 mm
Width	760 mm	730 mm	760 mm	730 mm	760 mm	730 mm	760 mm	730 mm
Depth	N/A	410 mm*	N/A	538 mm**	N/A	363 mm*	N/A	472 mm*

*^If you have a larger opening than the maximum height indicated, a surround kit is recommended. *Includes 25 mm clearance between flue spigot and rear wall.
**538 mm min clearance for straight through flue for the Fitzroy Powerflue and 472 mm for the Canterbury Powerflue. 588 mm min clearance for vertical flexi flue pipe (Fitzroy Powerflue). 522 mm min clearance for vertical flexi flue pipe (Canterbury Powerflue).*

Powerflue installation options

What sets Cannon **Powerflue** heaters apart?

- + Efficiency Rating: 5.5 stars for units with 400 mm long flue
- + Draws air from outside for combustion
- + Combustion products are expelled to atmosphere with the assistance of a combustion fan
- + Room sealed heater, means that combustion products can't return into the room
- + Cleaner and safer source of heating
- + Room air is not depleted from the living environment
- + Higher efficiency rating due to additional heat exchanger and improved combustion process
- + Flexible installation options
- + Can flue up to 6 metres maximum vertical, sideways or under floor
- + Can be installed in chimneys where integrity of chimney may be an issue
- + An extended flue kit is available as an accessory – Product Accessory Code: FLUEWFX
- + No need for zero clearance box
- + Mock kit supplied as standard
- + Heater can penetrate through external wall and be concealed with a weatherproof box

Standard heater operation.

Flue goes directly through the ceiling and roof.

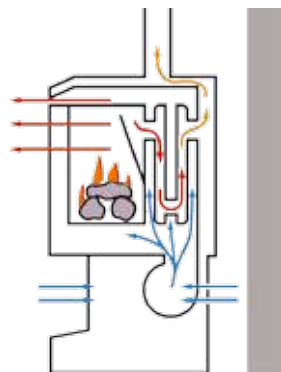

Powerflue operation.

Air is drawn in from outside for combustion via the air inlet and vented outside via the flue outlet.

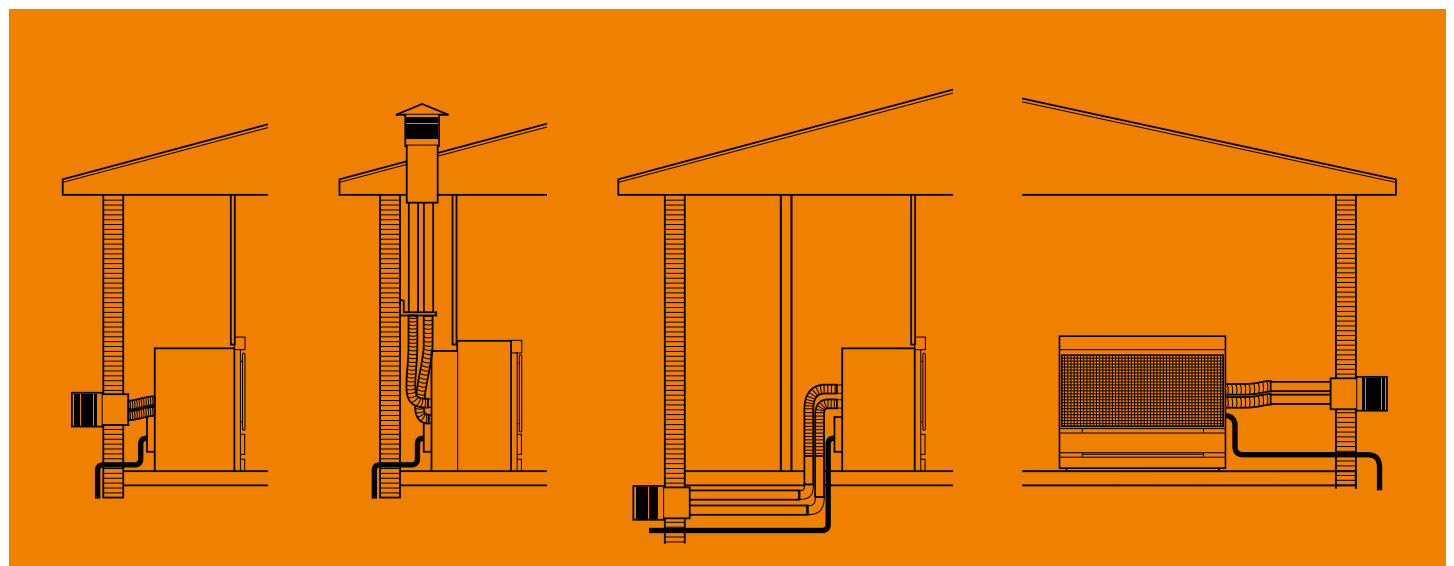
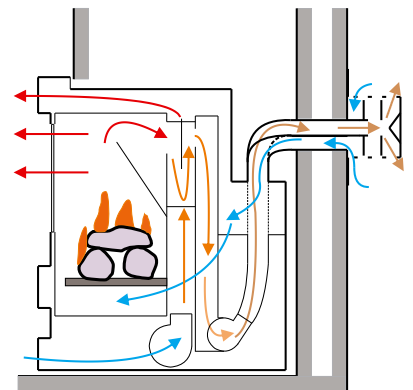

1 Horizontal installation from the back.

2 Vertical installation.

3 Under floor installation.

4 Sideways horizontal installation.

Image for illustrative purposes only.

Weather Proof Box dimensions

The weatherproof box is designed to be used on the Powerflue heaters that are installed on an external wall and protects the back of the heater from the elements. There are two flueing options – either on top of the weatherproof box or directly out the back. If flueing directly out the back (horizontally), the top hat is not required.

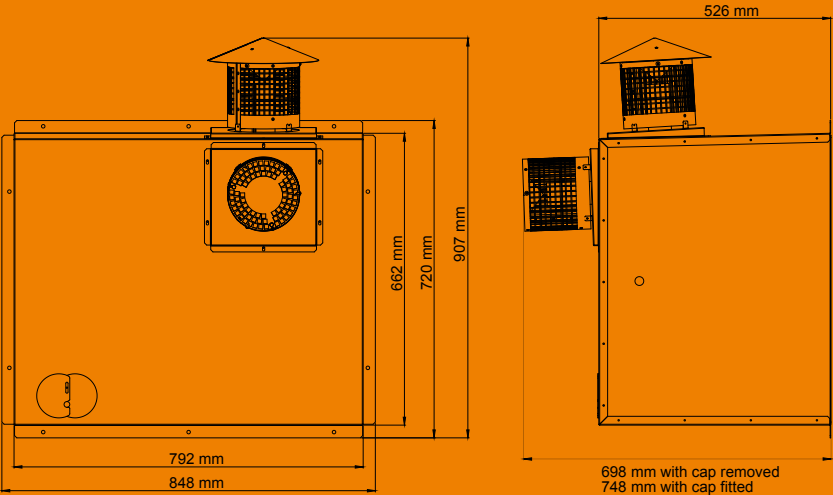

Console Kit dimensions

The Inbuilt Console Kit is designed to be used on the Fitzroy/Canterbury inbuilt heaters that are installed on an internal wall when there isn't enough depth for a full sized cavity.

	Fitzroy Inbuilt	Canterbury Inbuilt
A	808 mm	850 mm
B	651 mm	653 mm
C	435 mm	347 mm

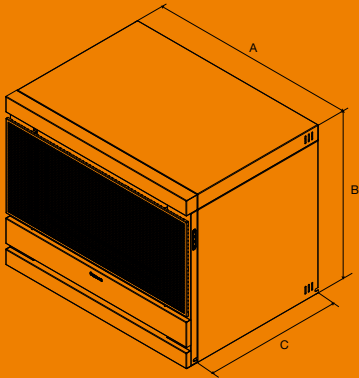

The Powerflue Console Kit is designed to be used on the Powerflue inbuilt heaters that are installed on an internal wall when there isn't enough depth for a full sized cavity.

	Fitzroy Powerflue	Canterbury Powerflue
A	808 mm	850 mm
B	651 mm	653 mm
C	540 mm	480 mm

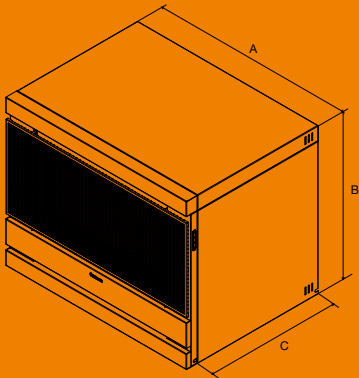

Surround & Spacer Kit dimensions

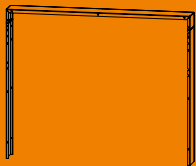

Spacer kit

	Fitzroy Inbuilt	Fitzroy Powerflue	Canterbury Inbuilt	Canterbury Powerflue
Height	651 mm	651 mm	655 mm	655 mm
Width	808 mm	808 mm	850 mm	850 mm
Depth	50 mm	50 mm	50 mm	50 mm

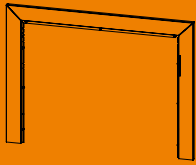

3 sided surround (75 mm)

	Fitzroy Inbuilt	Fitzroy Powerflue	Canterbury Inbuilt	Canterbury Powerflue
Height	725 mm	725 mm	730 mm	730 mm
Width	960 mm	960 mm	1000 mm	1000 mm
Depth	10 mm	10 mm	10 mm	10 mm

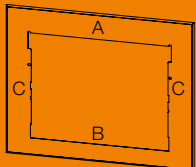

4 sided surround

	Fitzroy Inbuilt	Fitzroy Powerflue	Canterbury Inbuilt	Canterbury Powerflue
Height	850 mm	850 mm	850 mm	850 mm
Width	1045 mm	1045 mm	1045 mm	1045 mm
Depth	7 mm	7 mm	7 mm	7 mm
Frame	A – 95 mm B – 104 mm C – 119 mm	A – 95 mm B – 104 mm C – 119 mm	A – 91 mm B – 104 mm C – 98 mm	A – 91 mm B – 104 mm C – 98 mm

Fitzroy Profile series heater specifications

	Fitzroy Inbuilt	Fitzroy Freestanding	Fitzroy Powerflue
	FITZIB-SDENB FITZIB-SDENP	FITZIB-SDENB to be used with FITZFSKITX-B	FITZIB-PDEXB or FITZIB-PDEXP
Type	Inbuilt	Freestanding / top flue	Inbuilt Powerflue with variable flue options
Colours	Black or metallic platinum finish	Black finish	Black or metallic platinum finish
Gas consumption	26 MJ/hr	26 MJ/hr	26 MJ/hr
Gas type	Natural gas/LPG	Natural gas/LPG	Natural gas/LPG
Efficiency rating	3.6 stars ¹	3.6 stars ¹	5.5 stars ¹ for units with flue 600 mm long
Heat output	5.98 kW / 21.45 MJ/h	5.98 kW / 21.45 MJ/h	6.42 kW / 23.11 MJ/h
Heats on average	80 square metres (80 m ²)	80 square metres (80 m ²)	80 square metres (80 m ²)
Fan/heat settings	3 speed / 3 heat	3 speed / 3 heat	3 speed / 3 heat
Dimensions	Fascia	Overall	Fascia
Height	651 mm	863 mm	651 mm
Width	808 mm	808 mm	808 mm
Depth	50 mm	482 mm Min. distance from centre of flue to wall at rear of heater: 125 mm	50 mm

Installation

The purpose of these pages is to briefly illustrate the specifications. For full details refer to the comprehensive instructions included with the heater or visit www.cannonappliances.com.au. Whilst every effort is made to provide current information at the time this brochure was produced, continuing product development may mean the enclosed specifications, images and literature may differ.

Gas connection via a ½" copper compression fitting.

A 10 amp socket within 1.5 m is required. Inbuilt models can be direct wired with an accessible isolating switch

¹Tested to AS 4553:2008.

Fireplace opening (brick & masonry)

	Max	Min
Height	640 mm	605 mm
Width	760 mm	700 mm
Depth	N/A	410 mm*

Maximum length of flue: 4.5 m

Suitable for non-combustible or masonry/brick fireplaces or into a mock fireplace using a Mock Kit purchased separately.

Mock fireplace opening (combustible materials)[^]

	Max	Min
Height	640 mm	630 mm
Width	760 mm	730 mm
Depth	N/A	410 mm**

Kit comprising:

3 x 870 mm lengths of 125 mm dia. painted flue,
1 x 870 mm length of 125 mm dia. plain flue,
1 x ceiling ring,
1 x painted bottom flue spigot,
1 x 125 mm cowl,
1 x 100 –125 mm spigot plain Fasteners
Free standing casing

Maximum length of flue: 4.5 m (extra length of flue required)

Heater does not require non-combustible base. Can be installed against a combustible wall with clearances of 40 mm rear, 100 mm side and 900 mm in front of heater. Refer to installation instructions.

Fireplace opening (brick & masonry)

	Max	Min
Height	640 mm	605 mm
Width	760 mm	700 mm
Depth	N/A	538 mm

Dimensions of flue

Flue and air inlet through 50 mm diameter aluminium & PVC pipes 2 x 400 mm lengths of 50 mm flexible aluminium hose

Dimensions of flue terminal

Maximum length of flue: 6.0 m
Minimum length of flue: 130 mm
Flue terminal: 160 mm outer diameter. 150 mm deep (horizontal) 200 mm high (vertical)

See installation instructions for further details.

Mock Kit included with heater, may need to be removed from brick/masonry openings to allow fitment in openings less than 630 mm high.

Mock fireplace opening (combustible materials)[^]

	Max	Min
Height	640 mm	630 mm
Width	760 mm	730 mm
Depth	N/A	538 mm***

[^]If you have a larger opening than the maximum height indicated, a surround kit is recommended. *Includes 25 mm clearance between flue spigot and rear brickwork.

Includes 25 mm clearance between flue spigot and rear wall. *Includes 25 mm clearance between back of heater and rear wall and allows 50 mm clearance to bend flue in horizontal applications. We recommend 588 mm min depth (Fitzroy Powerflue) & 522 mm min depth (Canterbury Powerflue) in vertical flueing applications using flexible pipes. In the event space constraints inhibit the installation process, where it is not possible to maintain a 50 mm or 100 mm cavity depth clearance, for ease of installation these clearances can be reduced. However, under AS5601 guidelines a minimum clearance of 25 mm to combustibles MUST be maintained at all times.

When selecting the type of heater, consideration must be given as to the construction of the building with regards to ventilation. This will affect the efficiency of the type of flue selected and how it will operate – e.g. High Energy Efficient rated homes have little allowance for the introduction of fresh air for combustion purposes, therefore issues can arise with reverse flow of air through a standard flue in these homes. Two storey extensions to existing homes can also reduce the performance of standard flues. Avoid installing standard flue heaters on external perimeter walls of high pitched roof buildings to reduce the possibility of reversed air flow through the standard flue. If in doubt always select Powerflued models as these are not affected by these issues.

Canterbury Classic series heater specifications

	Canterbury Inbuilt	Canterbury Freestanding	Canterbury Powerflue																																																
	CANTIB-SDEEB	CANTFS-SDEEB	CANTIB-PDEEB / CANTIB-PDEEP																																																
Type	Inbuilt	Freestanding / top flue	Inbuilt Powerflue with variable flue options																																																
Colours	Black finish	Black finish	Black or metallic platinum finish																																																
Gas consumption	26 MJ/hr	26 MJ/hr	26 MJ/hr																																																
Gas type	Natural gas/LPG	Natural gas/LPG	Natural gas/LPG																																																
Efficiency rating	3.1 stars ¹	4 stars ¹	5.5 stars ¹ for units with flue 600 mm long																																																
Heat output	5.1 kW / 18.36 MJ/h	5.55 kW / 19.98 MJ/h	6.42 kW / 23.11 MJ/h																																																
Heats on average	80 square metres (80 m²)	80 square metres (80 m²)	80 square metres (80 m²)																																																
Fan/heat settings	3 speed / 3 heat	3 speed / 3 heat	3 speed / 3 heat																																																
Dimensions	Fascia	Overall	Fascia																																																
Height	655 mm	723 mm	653 mm																																																
Width	850 mm	650 mm	850 mm																																																
Depth	125 mm	425 mm Min. distance from flue centre to wall at rear of heater: Round – 115 mm.	125 mm																																																
Installation	<p>Fireplace opening (brick & masonry)</p> <table><tr><td></td><td>Max</td><td>Min</td></tr><tr><td>Height</td><td>640 mm</td><td>605 mm</td></tr><tr><td>Width</td><td>760 mm</td><td>700 mm</td></tr><tr><td>Depth</td><td>N/A</td><td>363 mm*</td></tr></table> <p>* Includes 25 mm clearance between flue spigot and rear brickwork.</p> <p>Maximum length of flue: 4.5 m</p> <p>Suitable for non-combustible fireplaces ie. masonry, brick or into a mock fireplace using a Mock kit purchased separately.</p> <p>Mock fireplace opening (combustible materials)^</p> <table><tr><td></td><td>Max</td><td>Min</td></tr><tr><td>Height</td><td>640 mm</td><td>630 mm</td></tr><tr><td>Width</td><td>760 mm</td><td>730 mm</td></tr><tr><td>Depth</td><td>N/A</td><td>363 mm**</td></tr></table>		Max	Min	Height	640 mm	605 mm	Width	760 mm	700 mm	Depth	N/A	363 mm*		Max	Min	Height	640 mm	630 mm	Width	760 mm	730 mm	Depth	N/A	363 mm**	<p>Flue kit comprising (purchase separately):</p> <p>3 x 870 mm lengths of 125 mm dia. painted flue, 1 x 870 mm length of 125 mm dia. plain flue, 1 x ceiling ring, 1 x 125 mm cowl, 1 x painted bottom flue spigot.</p> <p>Maximum length of flue: 4.5 m</p> <p>Heater does not require non-combustible base. Can be installed against a combustible wall with clearances of 40 mm rear, 100 mm side and 900 mm in front of heater. This model is to be installed with a Round Flue Kit part No. FLUERO-B purchased separately.</p>	<p>Fireplace opening (brick & masonry)</p> <table><tr><td></td><td>Max</td><td>Min</td></tr><tr><td>Height</td><td>640 mm</td><td>605 mm</td></tr><tr><td>Width</td><td>760 mm</td><td>700 mm</td></tr><tr><td>Depth</td><td>N/A</td><td>472 mm*</td></tr></table> <p>Dimensions of flue</p> <p>Flue and air inlet through 50 mm diameter aluminium & PVC pipes 2 x 400 mm lengths of 50 mm flexible aluminium hose</p> <p>Dimensions of flue terminal</p> <p>Maximum length of flue: 6.0 m Minimum length of flue: 130 mm Flue terminal: 160 mm outer diameter. 150 mm deep (horizontal) 200 mm high (vertical)</p> <p>See installation instructions for further details.</p> <p>Mock Kit included with heater, may need to be removed from brick/ masonry openings to allow fitment in openings less than 630 mm high.</p> <p>Mock fireplace opening (combustible materials)^</p> <table><tr><td></td><td>Max</td><td>Min</td></tr><tr><td>Height</td><td>640 mm</td><td>630 mm</td></tr><tr><td>Width</td><td>760 mm</td><td>730 mm</td></tr><tr><td>Depth</td><td>N/A</td><td>472 mm^^</td></tr></table>		Max	Min	Height	640 mm	605 mm	Width	760 mm	700 mm	Depth	N/A	472 mm*		Max	Min	Height	640 mm	630 mm	Width	760 mm	730 mm	Depth	N/A	472 mm^^
	Max	Min																																																	
Height	640 mm	605 mm																																																	
Width	760 mm	700 mm																																																	
Depth	N/A	363 mm*																																																	
	Max	Min																																																	
Height	640 mm	630 mm																																																	
Width	760 mm	730 mm																																																	
Depth	N/A	363 mm**																																																	
	Max	Min																																																	
Height	640 mm	605 mm																																																	
Width	760 mm	700 mm																																																	
Depth	N/A	472 mm*																																																	
	Max	Min																																																	
Height	640 mm	630 mm																																																	
Width	760 mm	730 mm																																																	
Depth	N/A	472 mm^^																																																	

The purpose of these pages is to briefly illustrate the specifications. For full details refer to the comprehensive instructions included with the heater or visit www.cannonappliances.com.au. Whilst every effort is made to provide current information at the time this brochure was produced, continuing product development may mean the enclosed specifications, images and literature may differ.

Gas connection via a ½" copper compression fitting.

A 10 amp socket within 1.5 m is required. Inbuilt models can be direct wired with an accessible isolating switch

¹Tested to AS 4553:2008.

^^Includes 25 mm clearance between back of heater and rear wall and allows 50 mm clearance to bend flue in horizontal applications. We recommend 588 mm min depth (Fitzroy Powerflue) & 522mm min depth (Canterbury Powerflue) in vertical flueing applications using flexible pipes. In the event space constraints inhibit the installation process, where it is not possible to maintain a 50 mm or 100 mm cavity depth clearance, for ease of installation these clearances can be reduced. However, under AS5601 guidelines a minimum clearance of 25 mm to combustibles MUST be maintained at all times.

Please note: All Cannon inbuilt heaters MUST be flued. We recommend our own Inbuilt flue kit be used which is purchased separately (model IBFLUEKIT).
The Powerflue heaters are supplied with the flue and cowl to be vented directly out the back through an external wall. If you wish to flue this unit vertically out through the roof or down under the floor the Extended Flue Kit will need to be purchased (model FLUEWFX).

Specifications standard features & optional accessories

Fitzroy Inbuilt Models					Fitzroy Powerflue Models			
	FITZIB-SDENB-NG	FITZIB-SDENB-LP	FITZIB-SDENP-NG	FITZIB-SDENP-LP	FITZIB-PDEXB-NG	FITZIB-PDEXB-LP	FITZIB-PDEXP-NG	FITZIB-PDEXP-LP
Standard Features								
Electronic ignition	•	•	•	•	•	•	•	•
3 heat settings	•	•	•	•	•	•	•	•
3 speed fan	•	•	•	•	•	•	•	•
Realistic eucalypt look logs	•	•	•	•	•	•	•	•
Standard flue	•	•	•	•				
Power flue					•	•	•	•
Double glass front	•	•	•	•	•	•	•	•
Panoramic view	•	•	•	•	•	•	•	•
Enhanced flame					•	•	•	•
Black finish	•	•			•	•		
Metallic platinum finish			•	•			•	•
Options								
Remote thermostat	o	o	o	o	o	o	o	o
Mesh kit	o	o	o	o	o	o	o	o
Spacer kit	o	o	o	o	o	o	o	o
Surround kit	o	o	o	o	o	o	o	o
Console kit	o	o	o	o	o	o	o	o
Weatherproof box					o	o	o	o
Mock fireplace kit	o	o	o	o	•	•	•	•
Freestanding kit (incl. flue kit)	o	o						
Extended flue kit					o	o	o	o
Inbuilt flue kit	o	o	o	o				
Canterbury Inbuilt Models		Canterbury Freestanding Models		Canterbury Powerflue Models				
	CANTIB-SDEEB-NG	CANTIB-SDEEB-LP	CANTIFS-SDEEB-NG	CANTIFS-SDEEB-LP	CANTIB-PDEEB-NG	CANTIB-PDEEB-LP	CANTIB-PDEEP-NG	CANTIB-PDEEP-LP
Standard Features								
Electronic ignition	•	•	•	•	•	•	•	•
3 heat settings	•	•	•	•	•	•	•	•
3 speed fan	•	•	•	•	•	•	•	•
Realistic eucalypt look logs	•	•	•	•	•	•	•	•
Standard flue	•	•	•	•				
Power flue					•	•	•	•
Double glass front	•	•	•	•	•	•	•	•
Enhanced flame	•	•	•	•	•	•	•	•
Black finish	•	•	•	•	•	•		
Metallic platinum finish							•	•
Options								
Remote thermostat	o	o	o	o	o	o	o	o
Spacer kit	o	o			o	o	o	o
Surround kit	o	o			o	o	o	o
Console kit	o	o			o	o	o	o
Weatherproof box					o	o	o	o
Mesh guard kit	o	o	o	o	o	o	o	o
Mock fireplace kit	o	o			•	•	•	•
Extended Flue Kit					o	o	o	o
Freestanding Flue Kit			•	•				
Inbuilt Flue kit	o	o						

• These items are supplied as standard with the heater o These items are not supplied with the heater and must be purchased separately

Fitzroy Profile dimensions

Fitzroy Inbuilt

FITZIB-SDENB or FITZIB-SDENP

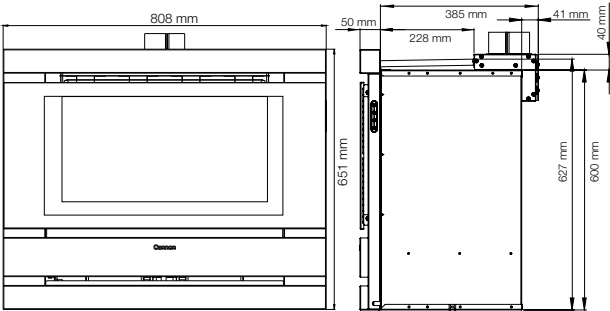
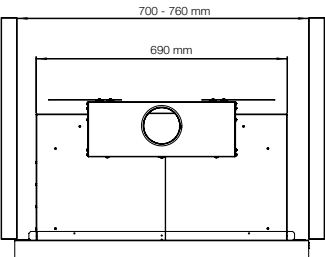
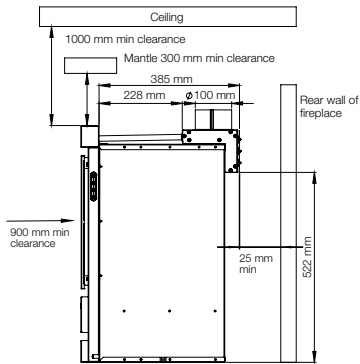

FOR INSTALLATIONS IN NON COMBUSTIBLE ENCLOSURES: (Refer to installation instructions for further details).

Fitzroy Freestanding

FITZIB-SDENB to be used with FITZFSKITX-B

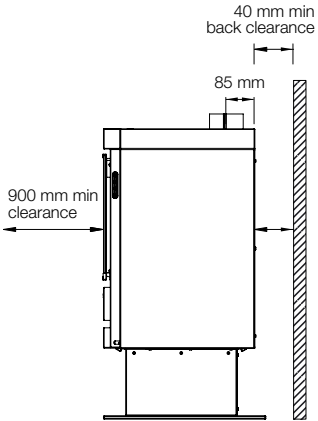
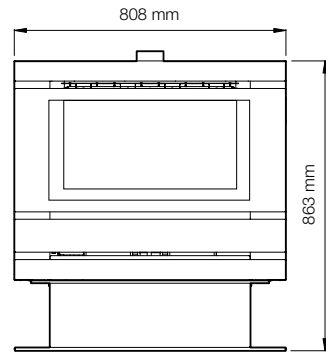
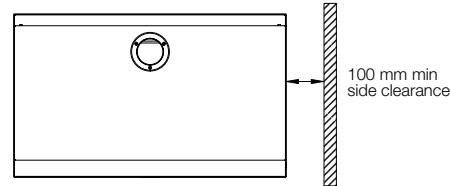
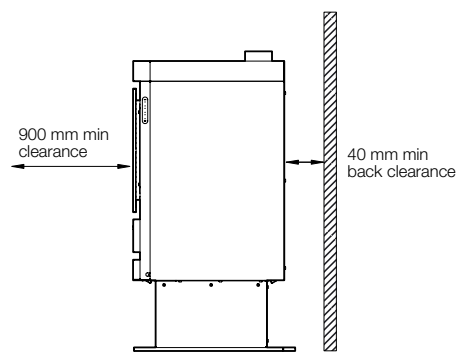

Fitzroy Powerflue

FITZIB-PDEXB or FITZIB-PDEXP

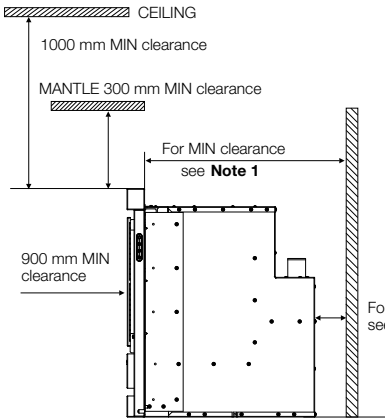

For further detailed flueing methods refer to our website for the installation instruction manual.
Note 1: 538 mm min clearance for horizontal flueing. 588 mm min clearance for vertical flex flue tubing.
Note 2: 50 mm min clearance for horizontal flueing. 100 mm min clearance for vertical flex flue tubing.

For MIN clearance see Note 2

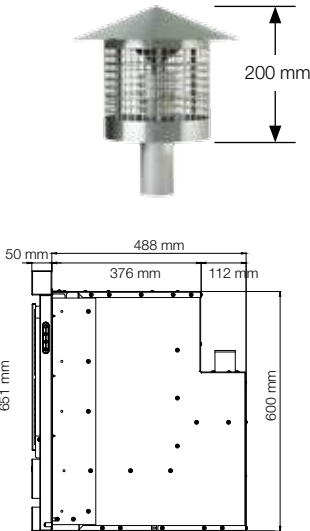
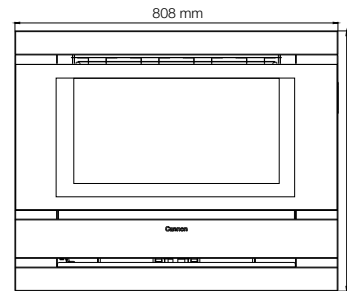
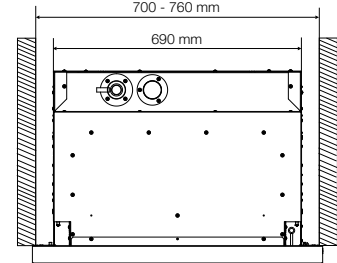

Canterbury Classic Series dimensions

Canterbury Inbuilt

CANTIB-SDEEB

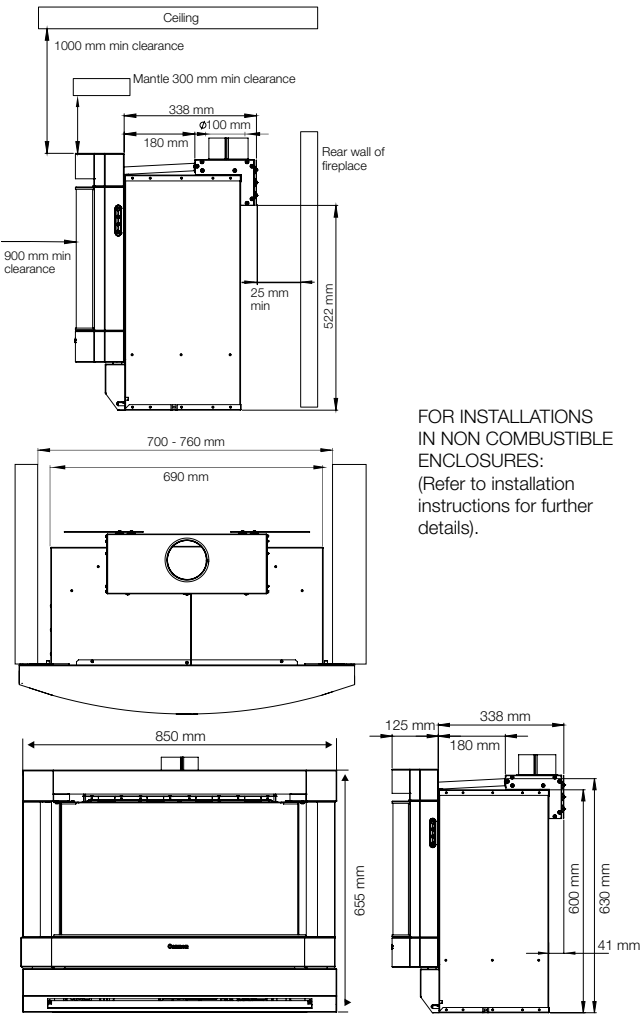

FOR INSTALLATIONS IN NON COMBUSTIBLE ENCLOSURES: (Refer to installation instructions for further details).

Canterbury Freestanding

CANTFS-SDEEB

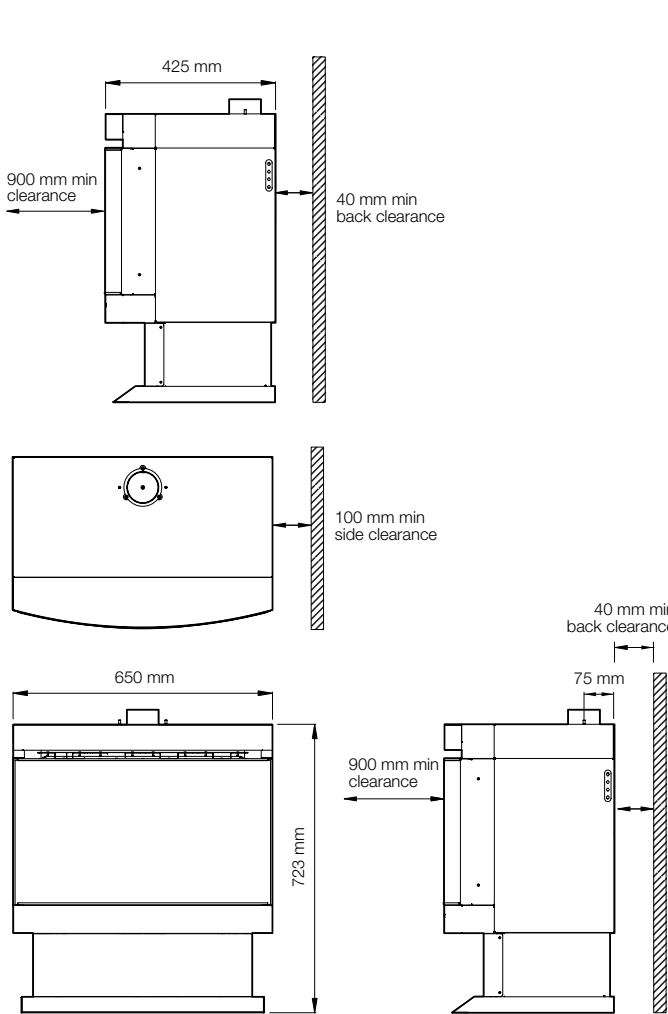

Canterbury Powerflue

CANTIB-PDEEB or CANTIB-PDEEP

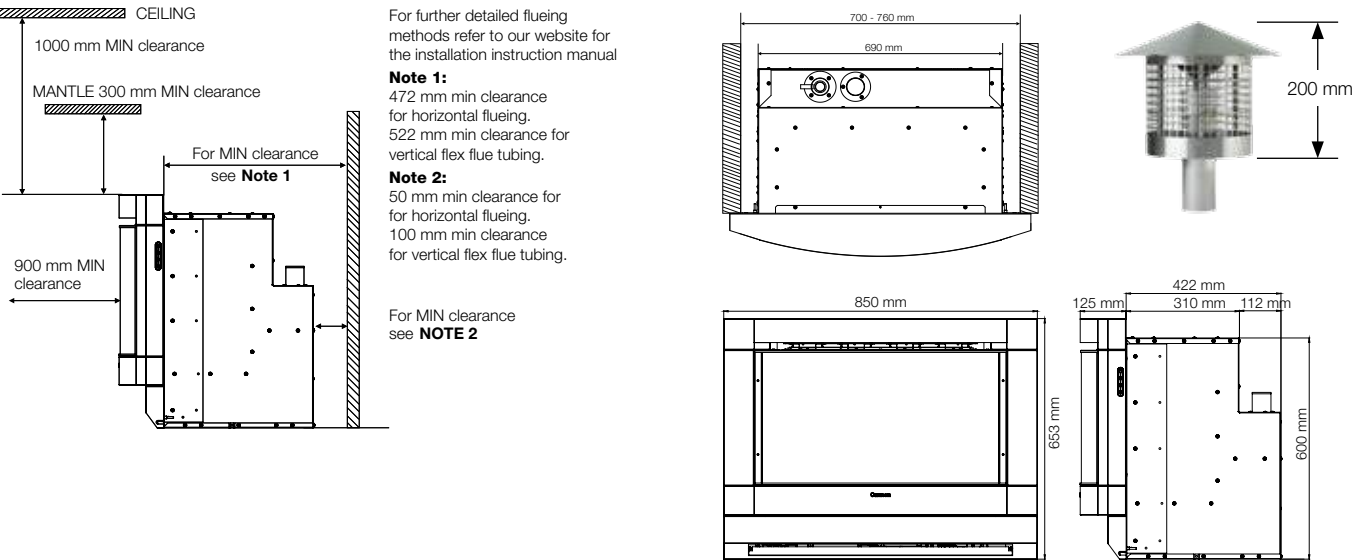

For further detailed flueing methods refer to our website for the installation instruction manual

Note 1: 472 mm min clearance for horizontal flueing. 522 mm min clearance for vertical flex flue tubing.

Note 2: 50 mm min clearance for horizontal flueing. 100 mm min clearance for vertical flex flue tubing.

For MIN clearance see **NOTE 2**

Sampford IXL

*Proudly manufactured and
distributed by Sampford IXL*

Sampford IXL Pty Ltd
1 Wood Street, South Geelong,
Victoria 3219
Telephone: 1300 727 421
Fax: 1300 727 425
www.cannonappliances.com.au

To locate your nearest retailer, view
product on display or for all national
enquiries contact 1300 727 421 or visit
www.cannonappliances.com.au

*While every effort is made to provide current
information at the time this brochure was
produced, continuing product improvements
mean the enclosed specifications, images
and literature may differ from what is
actually available.*

Part No. BRCAN0214



Cannon®
Gas Log Heaters