

KORADO[®]

RADIK[®] KLASIK



Australian
HYDRONIC SUPPLIES
HYDRONIC HEATING EQUIPMENT

6 Network Drive
Carrum Downs, Vic, 3201
Phone: 03 9708 2600
Fax: 03 9708 2700
www.hydronicsupplies.com.au

- 25 year warranty against design or manufacturing defects from the date of installation
- Made to last with long term anti-corrosion resistance and mechanical durability
- High quality finish achieved in a three stage process which gives the radiators a unique high gloss, scratch and corrosion resistant finish
- Pressure tested to 13 bar to guarantee safety for your family
- Low water content which saves you time and money
- Excellent packaging on all corners and edges no hassle when it comes to installing radiators
- Available in a wide range of colours to suit your design needs
- Available in:
200mm, 300mm, 400mm, 500mm
600mm, and 900mm high
- Widths from 400mm - 3000mm
- Type 11, 21, 22, 33

For technical
information PTO



RADIK® KLASIK - SPECIFICATIONS & TECHNICAL DATA

Type 11

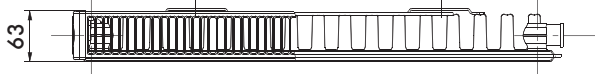

KORADO KLASIK TYPE 11 - Heat Output KW @ ΔT 60 (90/70/20°C)						
LENGTH mm	HEIGHT = mm					
	200	300	400	500	600	900
400		0.279	0.360	0.436	0.509	0.709
500		0.349	0.450	0.545	0.636	0.887
600		0.419	0.540	0.654	0.763	1.064
700		0.488	0.630	0.763	0.891	1.241
800		0.558	0.720	0.872	1.018	1.419
900		0.628	0.810	0.981	1.145	1.596
1000		0.698	0.900	1.090	1.272	1.773
1100		0.768	0.990	1.199	1.400	1.951
1200		0.837	1.080	1.308	1.527	2.128
1400		0.977	1.260	1.526	1.781	2.483
1600		1.117	1.439	1.744	2.036	2.838
1800		1.256	1.619	1.962	2.290	3.192
2000		1.396	1.799	2.180	2.545	3.547
2300		1.605	2.069	2.507	2.927	4.079
2600		1.814	2.339	2.834	3.308	4.611
3000		2.093	2.699	3.270	3.817	5.320

Type 21



KORADO KLASIK TYPE 21 - Heat Output KW @ ΔT 60 (90/70/20°C)						
LENGTH mm	HEIGHT = mm					
	200	300	400	500	600	900
400		0.379	0.477	0.569	0.657	0.899
500		0.474	0.596	0.711	0.821	1.123
600		0.569	0.716	0.854	0.985	1.348
700		0.663	0.835	0.996	1.149	1.573
800		0.758	0.954	1.138	1.314	1.797
900		0.853	1.074	1.281	1.478	2.022
1000		0.948	1.193	1.423	1.642	2.247
1100		1.042	1.312	1.565	1.806	2.471
1200		1.137	1.431	1.708	1.970	2.696
1400		1.327	1.670	1.992	2.299	3.145
1600		1.516	1.908	2.277	2.627	3.595
1800		1.706	2.147	2.561	2.956	4.044
2000		1.895	2.386	2.846	3.284	4.493
2300		2.180	2.743	3.273	3.777	5.167
2600		2.464	3.101	3.700	4.269	5.841
3000		2.843	3.578	4.269	4.926	6.740

Type 22

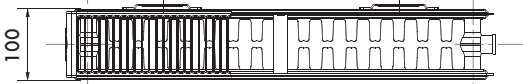

KORADO KLASIK TYPE 22 - Heat Output KW @ ΔT 60 (90/70/20°C)						
LENGTH mm	HEIGHT = mm					
	200	300	400	500	600	900
400		0.492	0.620	0.741	0.857	1.185
500		0.616	0.775	0.926	1.071	1.481
600		0.739	0.930	1.111	1.285	1.777
700		0.862	1.085	1.296	1.499	2.074
800	0.623	0.985	1.240	1.481	1.713	2.370
900		1.108	1.395	1.666	1.928	2.666
1000	0.779	1.231	1.550	1.852	2.142	2.962
1100		1.354	1.705	2.037	2.356	3.259
1200	0.935	1.477	1.860	2.222	2.570	3.555
1400		1.723	2.170	2.592	2.999	4.147
1600	1.091	1.970	2.480	2.963	3.427	4.740
1800		2.216	2.790	3.333	3.855	5.332
2000		2.462	3.100	3.703	4.284	5.925
2300		2.831	3.565	4.259	4.926	6.814
2600		3.201	4.030	4.814	5.569	7.702
3000		3.693	4.650	5.555	6.425	8.887

Type 33



KORADO KLASIK TYPE 33 - Heat Output KW @ ΔT 60 (90/70/20°C)						
LENGTH mm	HEIGHT = mm					
	200	300	400	500	600	900
400		0.699	0.883	1.059	1.229	1.707
500		0.874	1.104	1.324	1.537	2.133
600		1.048	1.325	1.589	1.844	2.560
700		1.223	1.546	1.854	2.152	2.987
800		1.398	1.766	2.119	2.459	3.413
900		1.572	1.987	2.384	2.766	3.840
1000		1.747	2.208	2.649	3.074	4.267
1100		1.922	2.429	2.914	3.381	4.693
1200		2.097	2.650	3.178	3.688	5.120
1400		2.446	3.091	3.708	4.303	5.973
1600		2.795	3.533	4.238	4.918	6.826
1800		3.145	3.974	4.768	5.533	7.680
2000		3.494	4.416	5.297	6.147	8.533
2300		4.018	5.078	6.092	7.070	9.813
2600		4.542	5.741	6.886	7.992	11.093
3000		5.241	6.624	7.946	9.221	12.800

Type	11	21	22	33
X1	55 / 75	56 / 76	73 / 93	73 / 93
X2	86 / 106	88 / 108	123 / 143	178 / 198

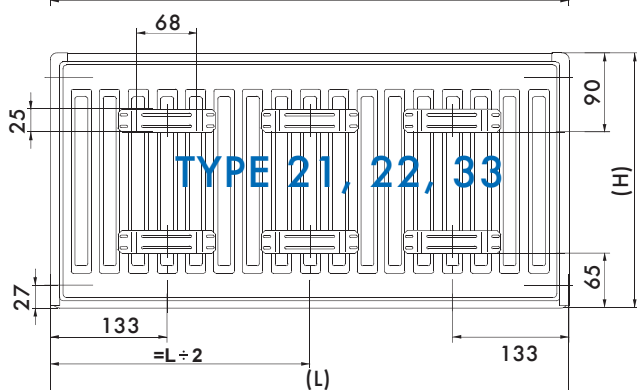
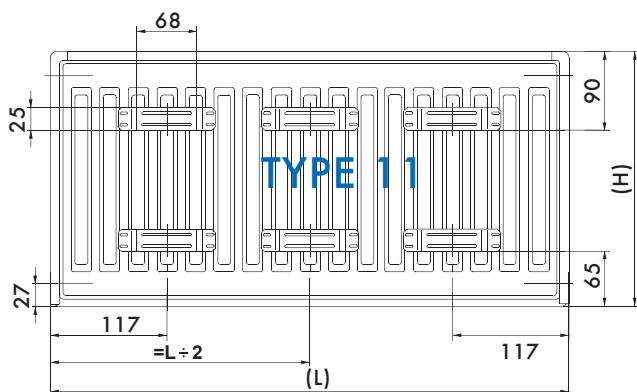

Middle Hanging Strap = $L + 2$ / Refers to Radiators 1800mm - 3000mm

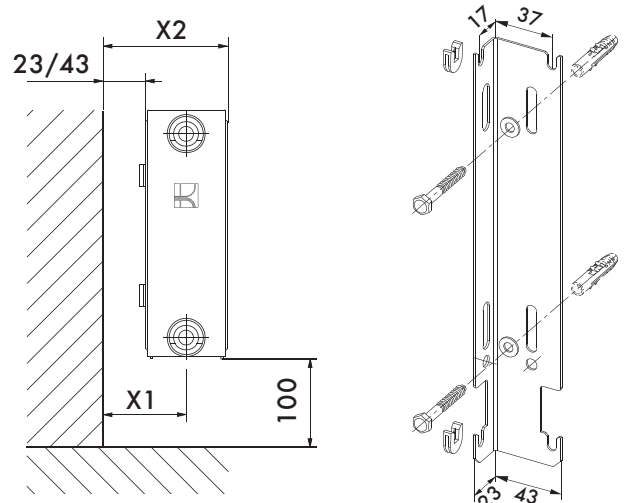

Connection Examples

